



# CONTRIBUTOR RESERVATION FORM

## Contributor Reservation Form

**Note: Payments must accompany order.**

Exhibiting Company Name: \_\_\_\_\_ Booth # \_\_\_\_\_

Contact Person: \_\_\_\_\_

Phone: \_\_\_\_\_ Fax: \_\_\_\_\_

Email: \_\_\_\_\_

Address: \_\_\_\_\_

City: \_\_\_\_\_ State: \_\_\_\_\_ Zip: \_\_\_\_\_

### Opening Reception Participating Contributor

Monday, November 13, 7:00pm – 9:00pm, Exhibit Hall

Investment: Contributors provide \$1,250 per food station.

I want to contribute to \_\_\_\_\_ food stations (10 available) at a cost of \$1,250 per food station. ?

### Conference Tote Bag Insert (limit : 5 Contributors)

\_\_\_\_\_ I want my insert as part of the Conference Tote Bag. Investment: \$5,000

*Contributor's Responsibilities:*

- Contributors are responsible for producing 3,500 inserts; this includes shipping the inserts to the event. (Shipping instructions to follow.)
- \* SC Exhibits Management must approve insert items. Sponsor must supply sample to SC Exhibits Management by October 20, 2006

### Conference Pens Contributor Opportunity (*exclusive*)

\_\_\_\_\_ I want my company's pens inserted into the Conference Bags. Investment: \$2,000

*Contributor's Responsibilities:*

- Contributors are responsible for producing 3,500 pens; this includes shipping the pens to the event. (Shipping instructions to follow.)

**Convention Center Banners – There will be a limit of 8 total banners from the 15 locations.**

**I would like to reserve banner position:**

Upper Rotunda

\_\_\_\_\_ 1. (6'h x up to 100' w): investment: \$6,000

East Seating Pod

\_\_\_\_\_ 2. Left Side (6'h x 12'w): investment: \$6,000

\_\_\_\_\_ 3. Right Side (6'h x 12'w): investment: \$6,000

West Seating Pod

\_\_\_\_\_ 4. Left Side (6'h x 12'w): investment: \$6,000

\_\_\_\_\_ 5. Right Side (6'h x 12'w): investment: \$6,000

Walls seen as leaving Exhibit Hall

- \_\_\_\_\_ 6. East Wall (6'h x 20' w): investment: \$6,000
- \_\_\_\_\_ 7. East Wall (6'h x 20' w): investment: \$5,000
- \_\_\_\_\_ 8. Center Wall (6'h x 20' w): investment: \$6,000
- \_\_\_\_\_ 9. Center Wall (6'h x 20' w): investment: \$6,000
- \_\_\_\_\_ 10. West Wall (6'h x 20' w): investment: \$6,000
- \_\_\_\_\_ 11. West Wall (6'h x 20' w): investment: \$6,000

East Entrance

- \_\_\_\_\_ 12. (6'h x 6' w): investment: \$6,000
- \_\_\_\_\_ 13. (6'h x 6' w): investment: \$6,000

West Entrance

- \_\_\_\_\_ 14. (6'h x 6' w): investment: \$6,000
- \_\_\_\_\_ 15. (6'h x 6' w): investment: \$6,000

**Installation and dismantling labor are included in each package price.**

*Contributor's Responsibilities:*

Contributors are responsible for production of banner; this includes shipping banners to Freeman Advance Receiving Warehouse by November 1, 2006. Note: banners should be shipped separately from your exhibit display shipment. Please use special shipping labels, provided under separate cover.

**Free Standing Sign (limit: 10)**

**I would like to reserve 8'h X 3'w double-sided free standing sign to be placed in a high traffic location. Investment: \$2,000 per sign.** Note: includes production costs. Sign dimensions 87" h X 38.125"w.

Contributor's Responsibility:

Contributor must supply suitable graphic file by October 20, 2006. Specifications on graphic file: EPS/Vector file. Resolution should be 72 DPI at full size.

**Lanyards (limit: 3 organizations)**

**\_\_\_\_\_ I want my company's lanyards distributed in the Registration Area. Investment: \$3,000. Attendees may choose lanyards from up to three different organizations.**

Contributors are responsible for production of lanyards. Lanyards are to be delivered to the Exhibits Office – Room 34 by Saturday, November 11.

**Cancellations**

Cancellations of Contributor reservations are not accepted after the closing date of September 8, 2006 for SC06.

**Make check payable to: ACM/IEEE SC2006**

**Mail checks to:**

ACM/IEEE SC06,  
19 Mantua Road  
Mt. Royal, NJ 08061

**Mail reservation form to:**

SC06 Exhibition Management,  
Hall-Erickson, Inc.,  
98 E. Naperville Road, Suite 201,  
Westmont, IL 60559-1559 USA

**If you have any questions, please contact:**

Rory Bolen  
SC06 Exhibits Management  
630-434-7779  
e-mail: sc@heiexpo.com

# SC06 Banner Locations

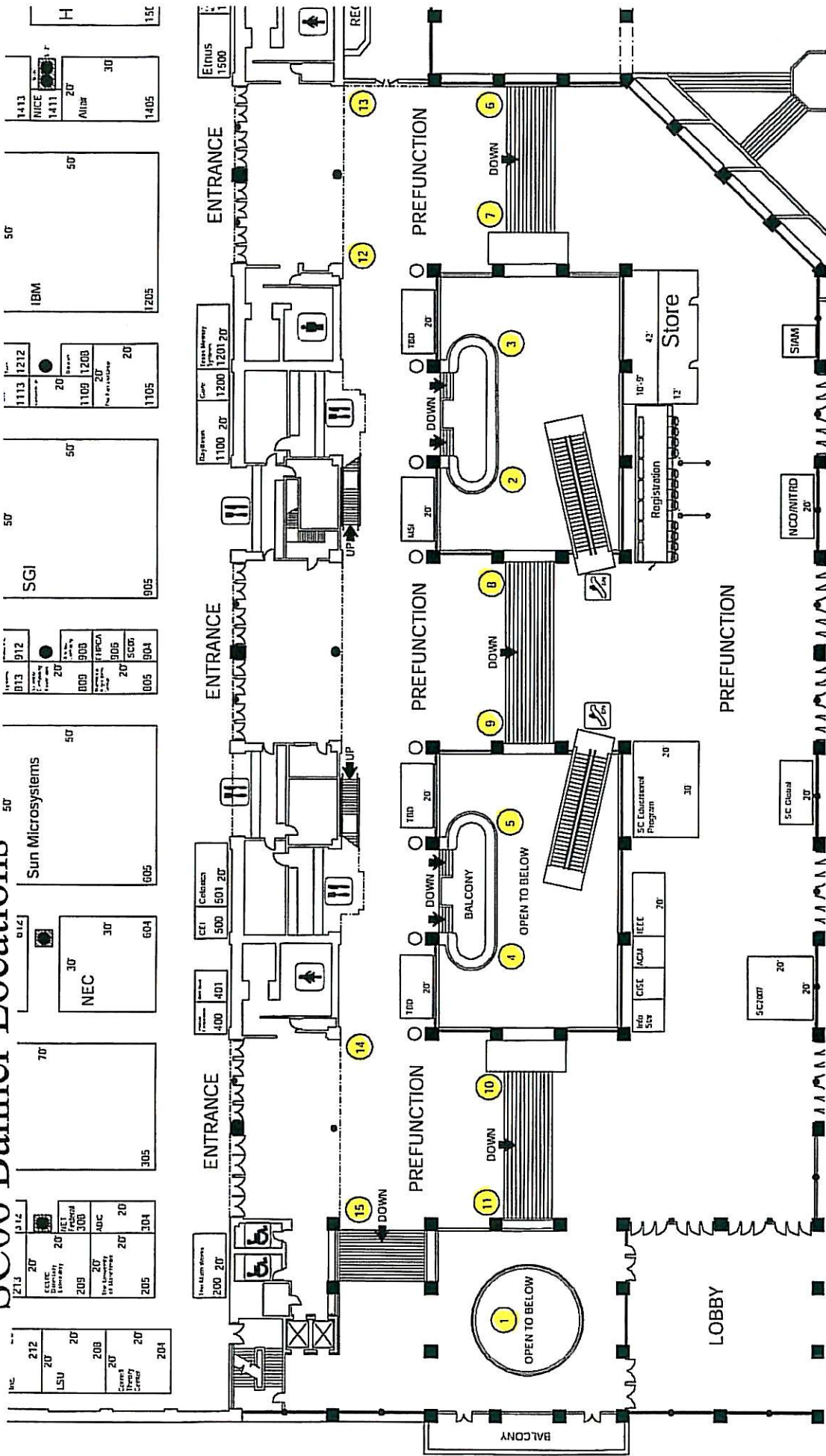

Banners 6, 7, 8, 9, 10, and 11 can only be seen when exiting the hall.

# Banner #1 upper Rotunda

**YOUR COMPANY  
GRAPHICS HERE**

**6' HIGH  
UPTO  
100'  
AROUND**

grommets and pole  
pockets top and pole  
pocket bottom

# SAMPLE BANNER

# F R E E M A N

# Banner #2 East seating pod

**YOUR COMPANY  
GRAPHICS HERE**  
6' x 12'

**YOUR COMPANY  
GRAPHICS HERE**  
6' x 12'

grommets and pole  
pockets top and pole  
pocket bottom

Banner #4 walls as you exit-2 over each  
of the three stairways total of six

**YOUR COMPANY  
GRAPHICS HERE**

6' x 20'

grommets and pole  
pockets top and pole  
pocket bottom

# Banner #3 West seating pod

**YOUR COMPANY  
GRAPHICS HERE**  
6' x 12'

**YOUR COMPANY  
GRAPHICS HERE**  
6' x 12'

grommets and pole  
pockets top and pole  
pocket bottom

# Banner #6 West entrance

**YOUR  
COMPANY  
GRAPHICS  
HERE**

6' x 6' (2)

grommets and pole  
pockets top and pole  
pocket bottom

# Banner #5 East entrance

**YOUR  
COMPANY  
GRAPHICS  
HERE**

6' x 6' (2)

grommets and pole  
pockets top and pole  
pocket bottom